



cross  care

Kate Corrigan, Ee Jia Goh ,
Viktorija Malakauskaite.

Crosscare is the social support agency of the Dublin Archdiocese (the district under the supervision of an archbishop). Since 1941 Crosscare has been delivering services to those who need them most in the greater Dublin area. These services are currently run from nearly 90 locations throughout the Dublin Archdiocese.

Portland row: the main customers in Portland row are:

- Elderly
- Drug addicts
- Young adults

Portland row:





Hand drawn sketches:

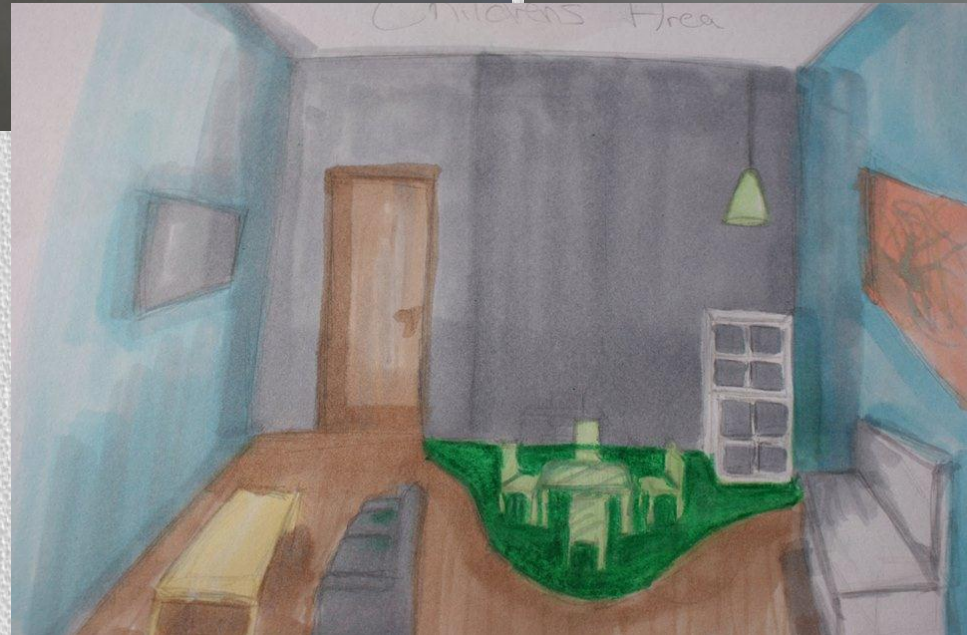
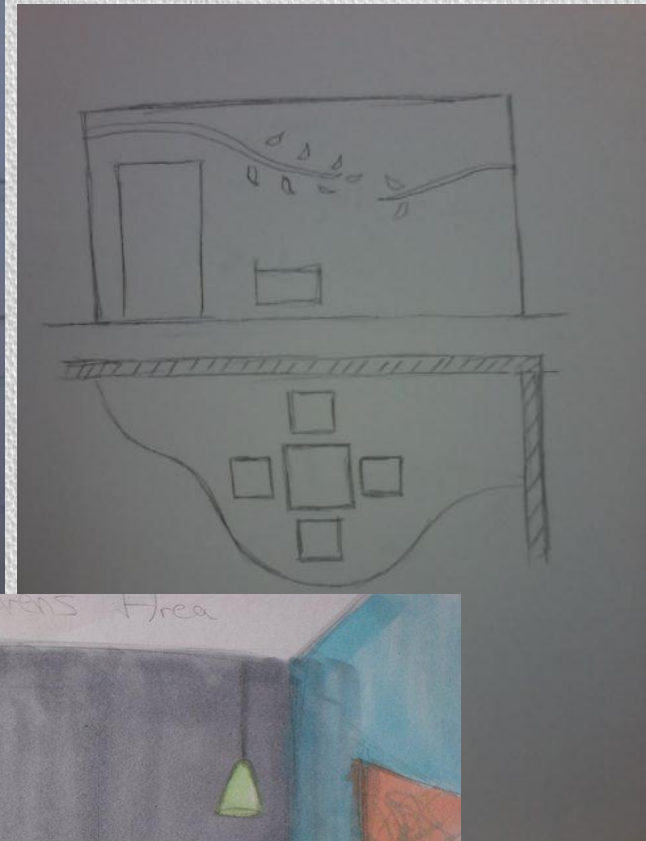
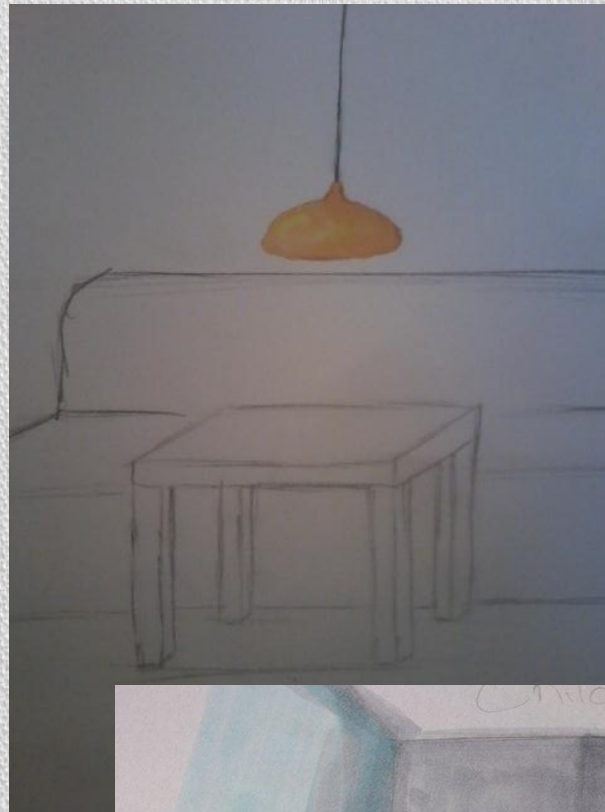
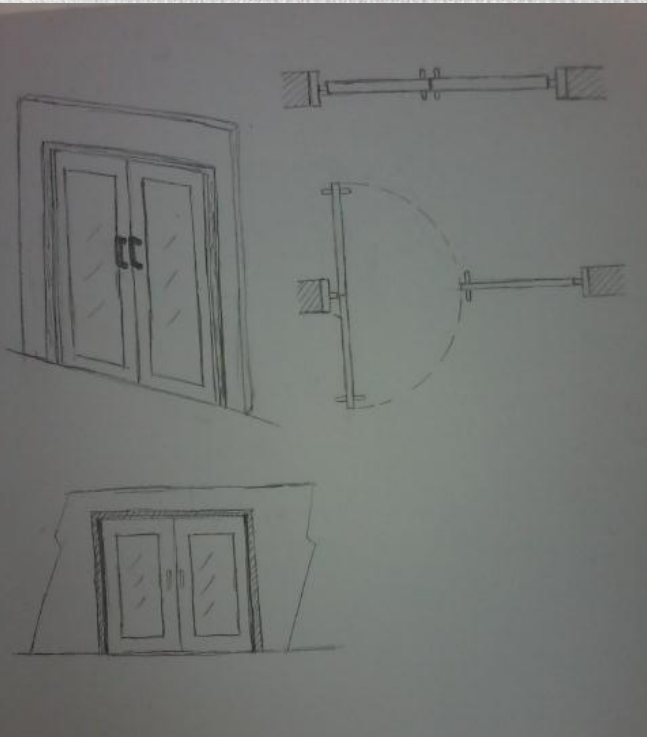

Eating areas:

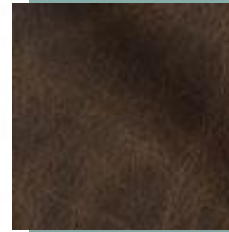

Computer area:



Reception area:



Relax area:

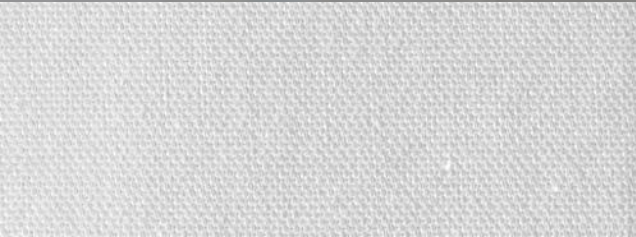

Back wall:

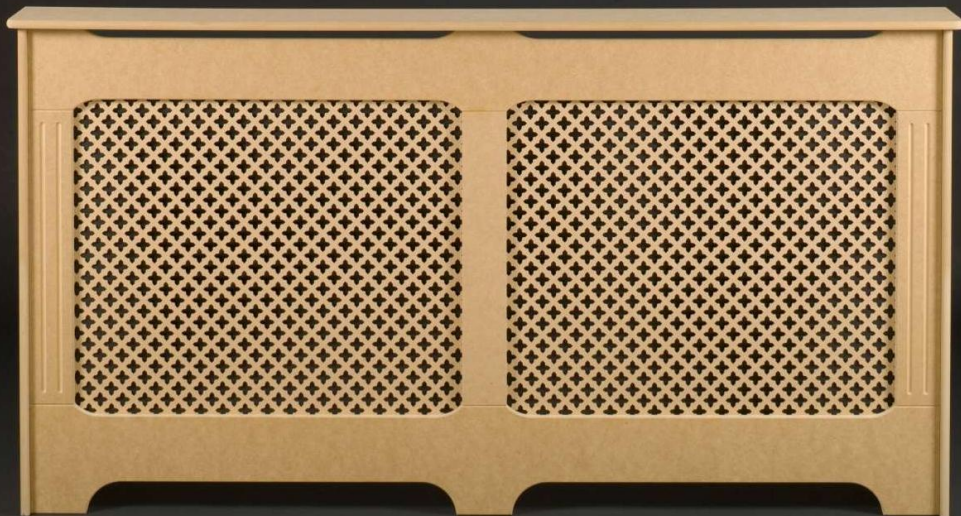

Children's play area:



Layout plan:

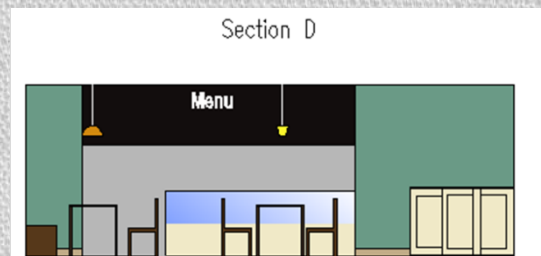
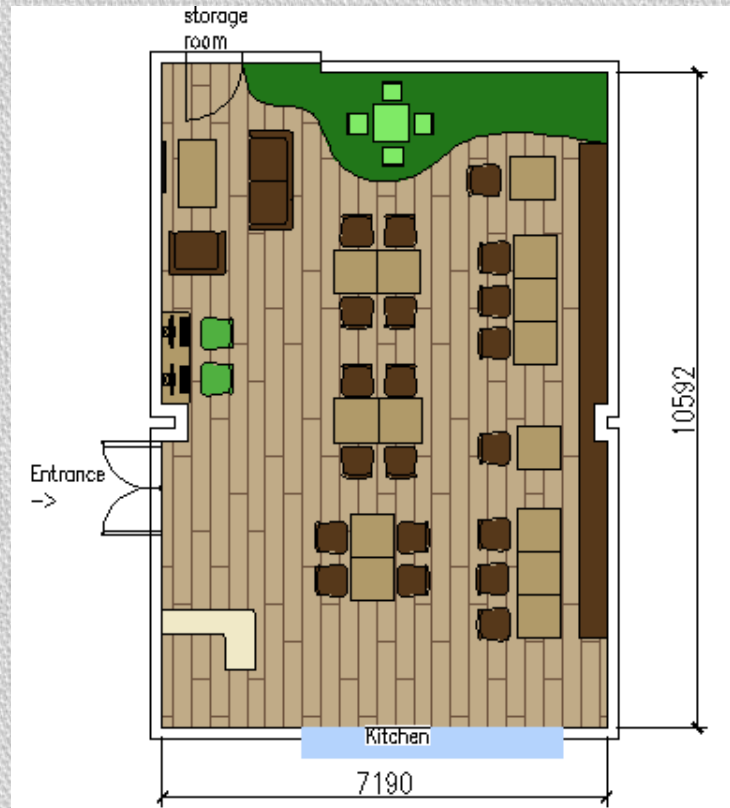
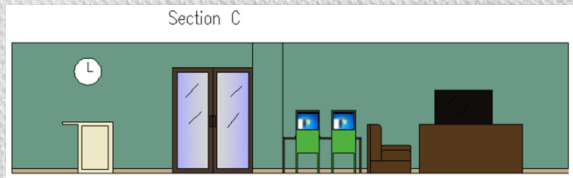

Elevations:

Section A



Section C

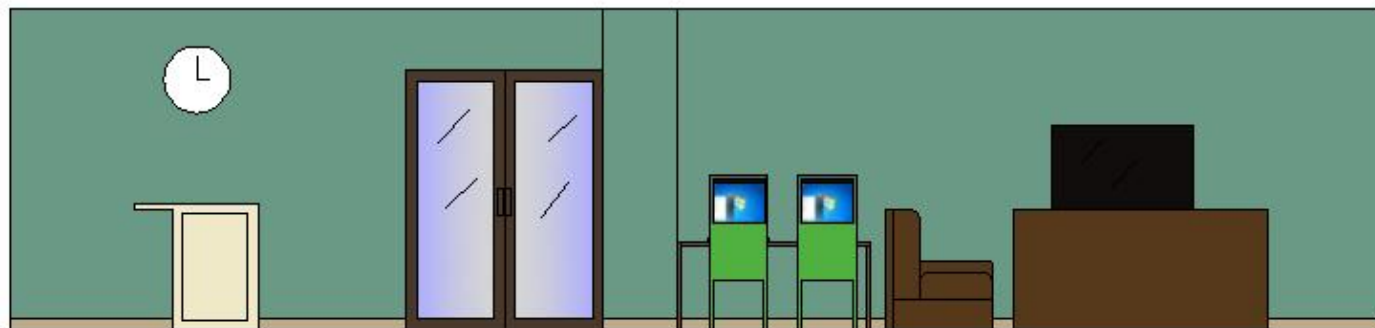

Elevations

Section B



Section D

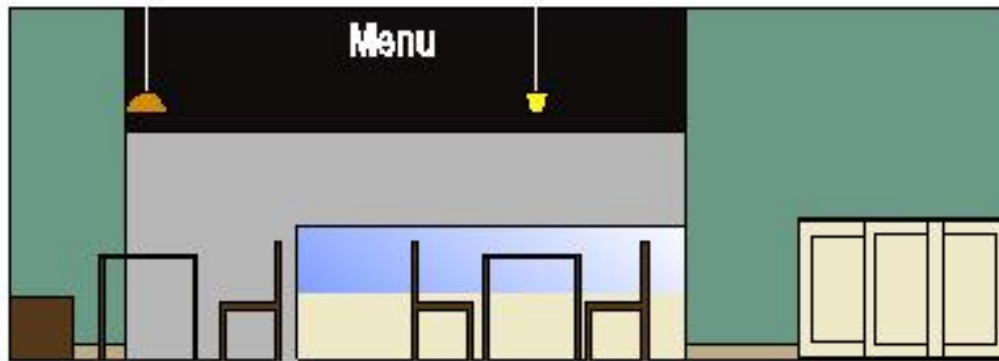

Lighting plan:

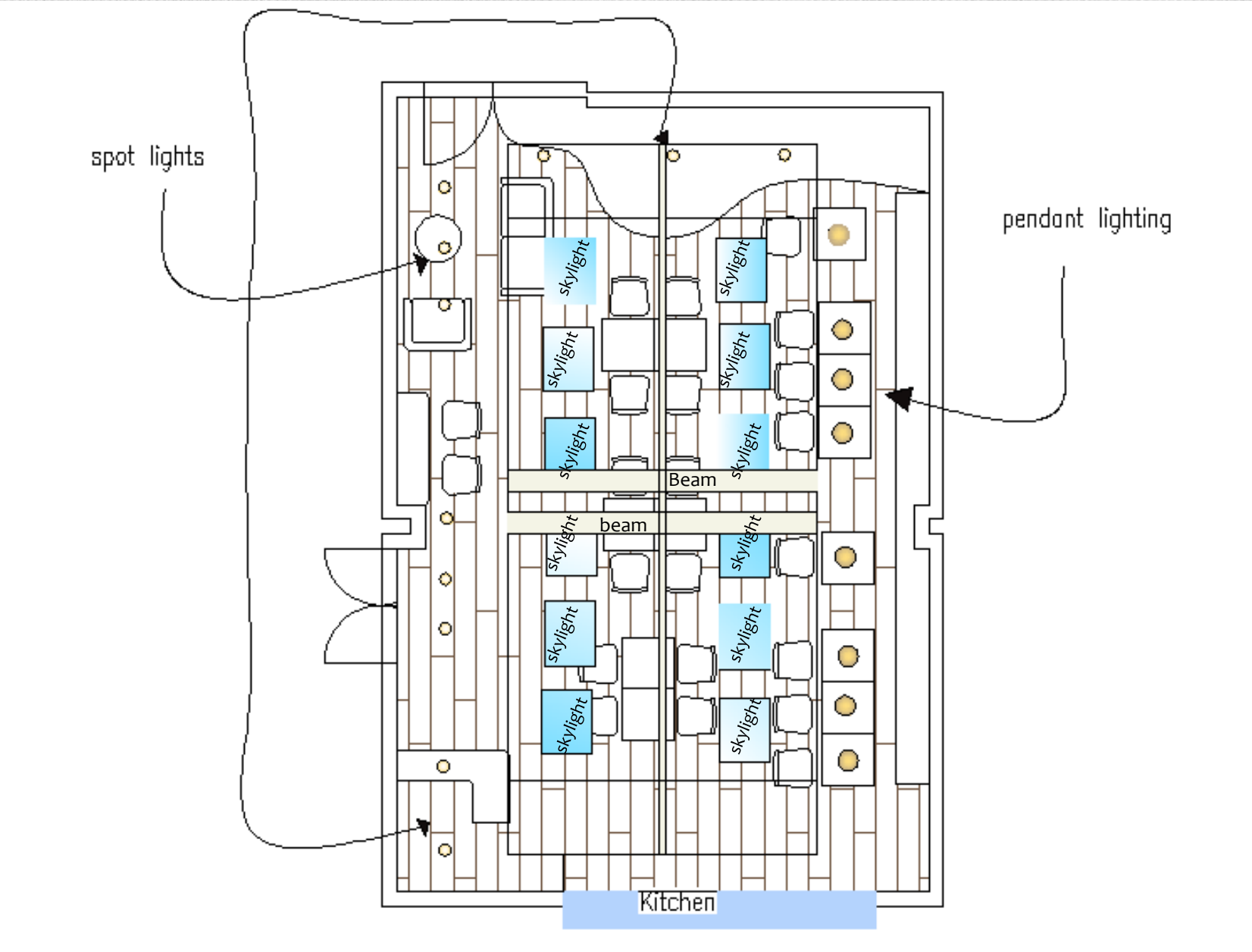

3D visual no.1: Entrance and back wall



3D visual no.2: Right side wall and back wall



View no.1: From the entrance



View no.2: From the entrance



View no.3: Reception desk



View no.4:





Thank you!
Kate Corrigan, Ee Jia Goh ,
Viktorija Malakauskaite.